

GEARBOX CASING COMPONENTS

1. Front cover.
2. Front cover oil seal.
3. Front cover gasket.
4. Oil drain plug and washer.
5. Oil level plug.
6. Gearbox main casing.
7. Spool retainer.
8. Gasket.
9. Inboard detent ball and spring.
10. Reverse lever and slipper.
11. Locating dowels - centre plate to maincase.
12. Reverse lever pivot post.
13. Centre plate.
14. Selector plug, detent ball and spring.
15. Gasket.
16. Fifth gear selector bracket.
17. Fifth gear selector fork.
18. Reverse gear shaft.
19. Oil pick-up pipe.
20. Oil pump drive shaft.
21. Oil pump gears and cover.
22. Fifth gear extension housing.
23. Fifth gear extension housing drain plug and filter.
24. Ferrobestos bush.
25. Oil seal.

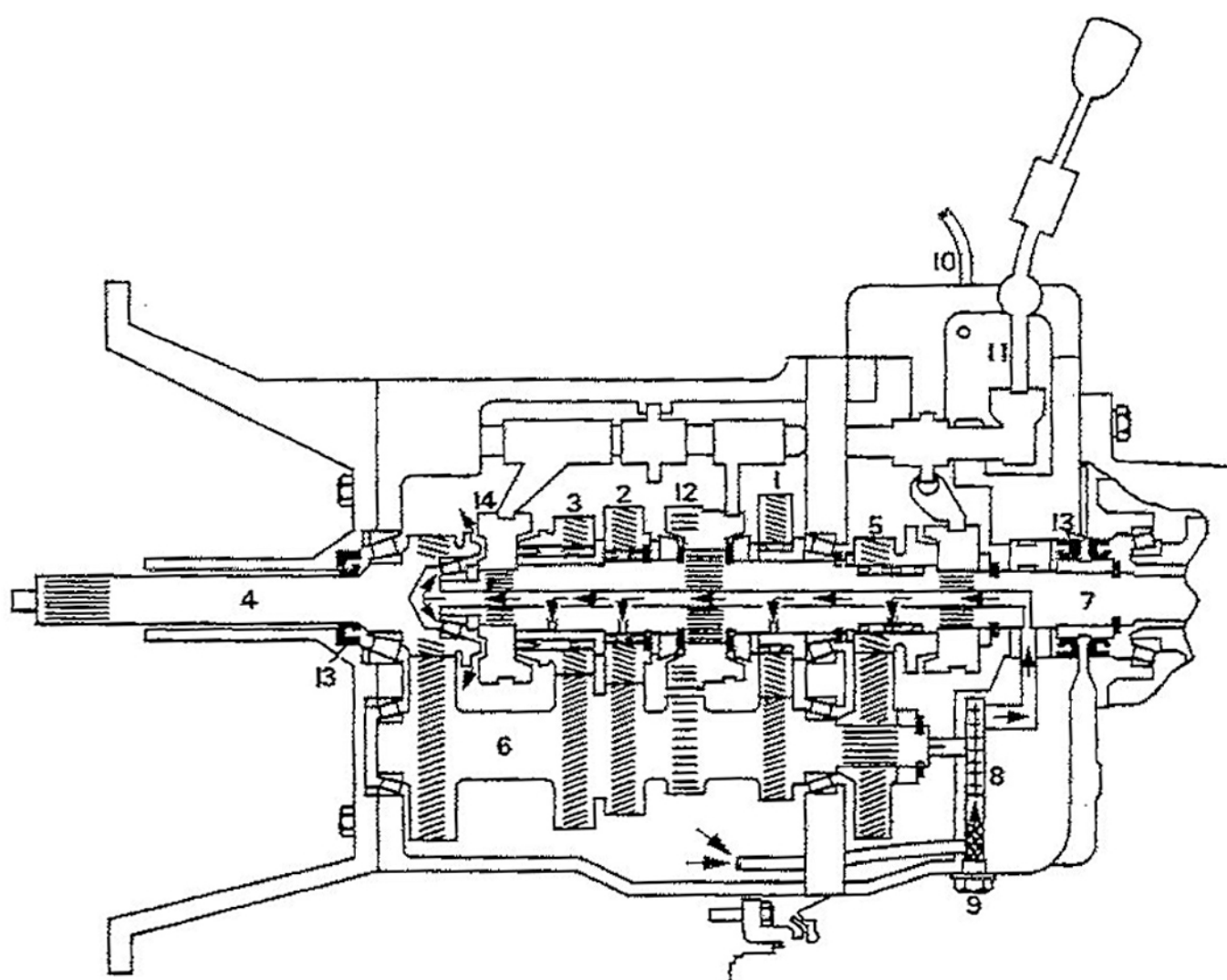
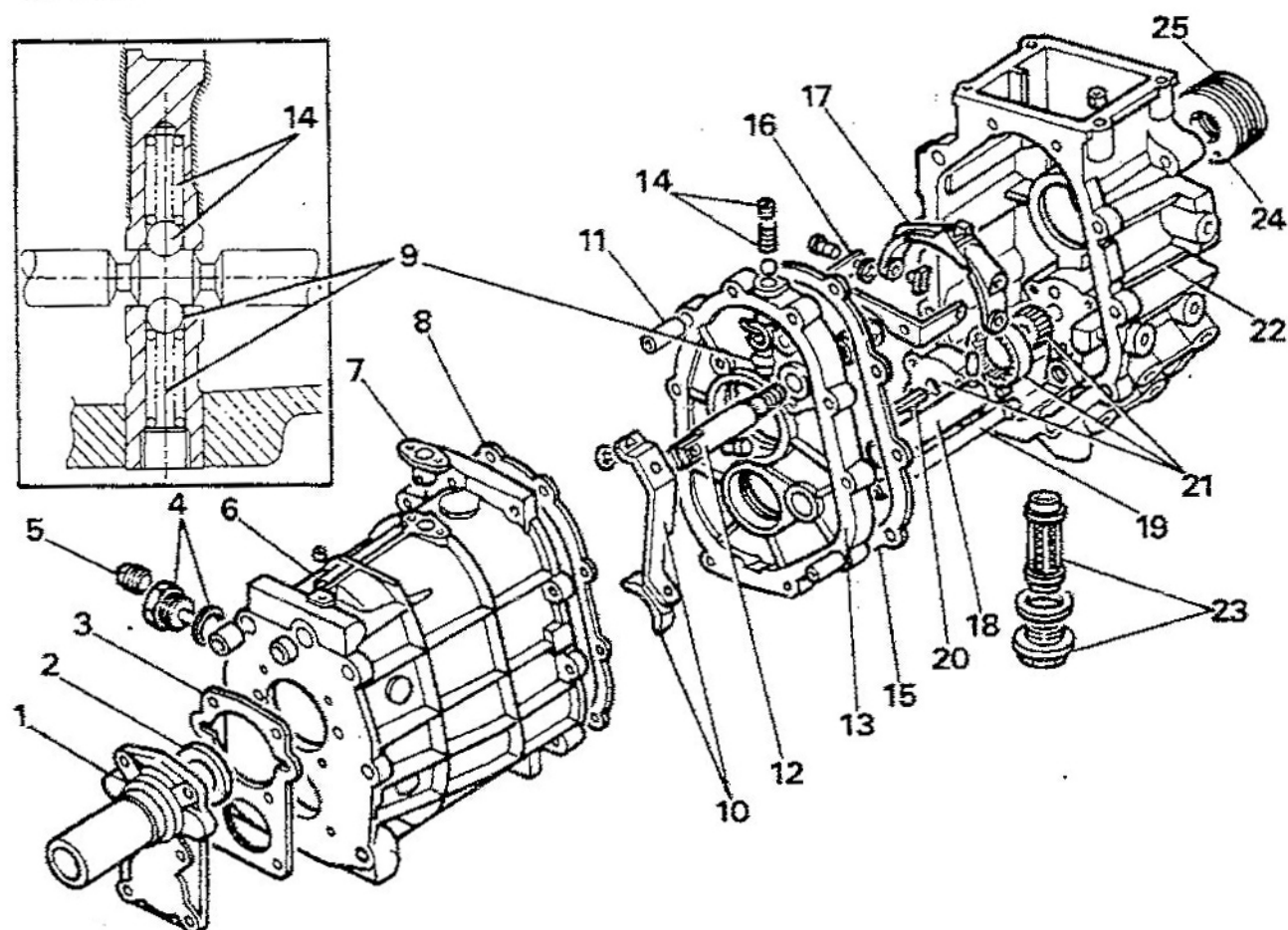

RR3568M

1. Mainshaft 1st gear
2. Mainshaft 2nd gear
3. Mainshaft 1st gear
4. Primary input shaft
5. Mainshaft 5th gear
6. Layshaft
7. Mainshaft
8. Lubrication pump
9. Drain plug and oil filter
10. Ventilation pipe
11. Single rail gear shift
12. 1st/2nd synchromesh
13. Oil seals
14. 3rd/4th synchromesh
15. 5th gear synchromesh